

A B C D E F G H J

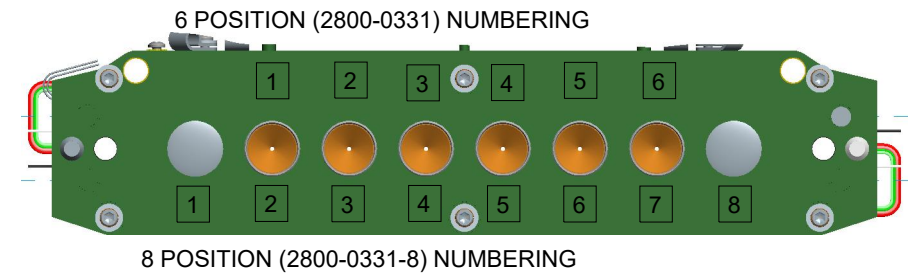
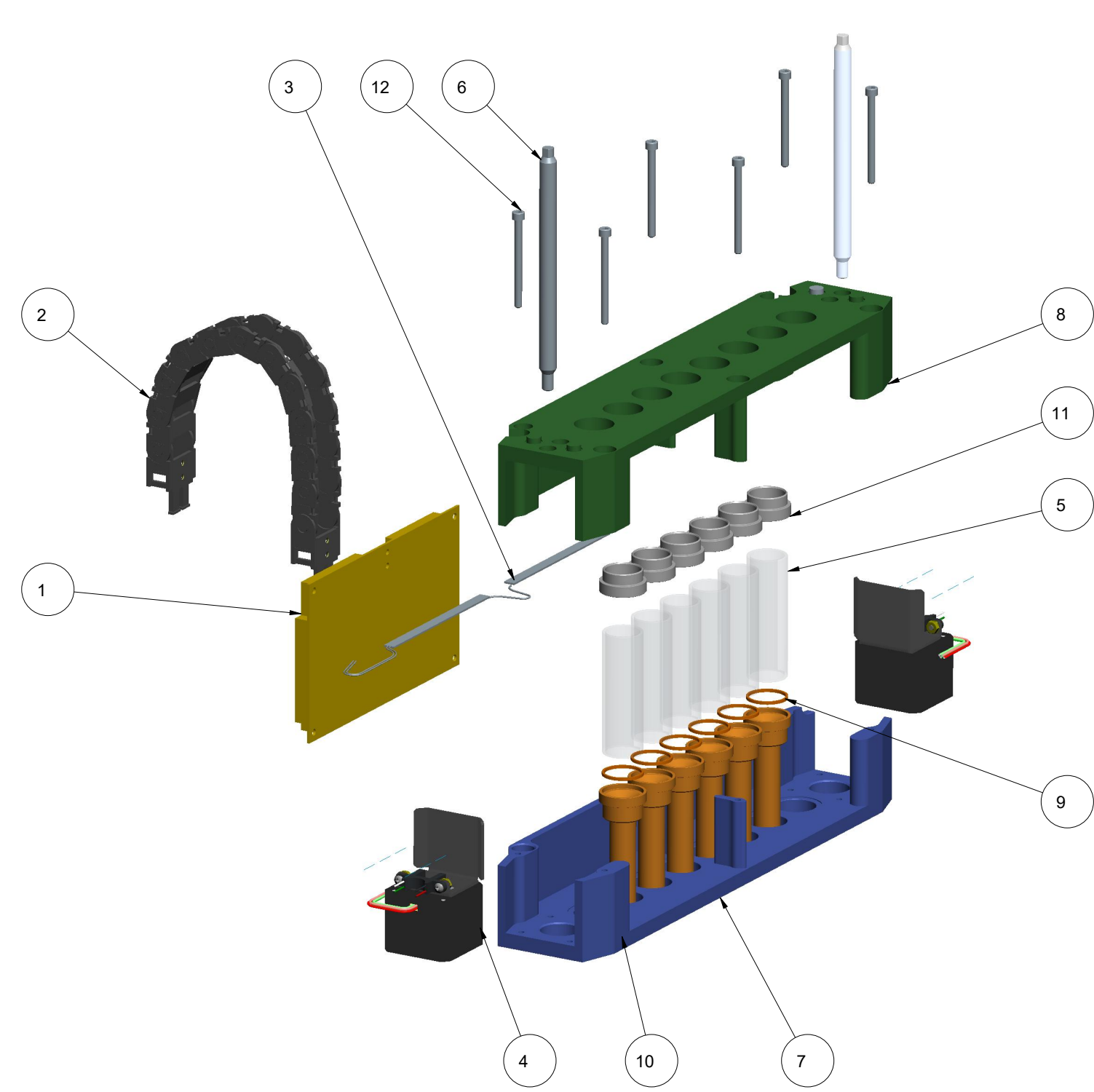

12	5510-0159	S/S SOC HD CAP SCREW #8-32 X 2" LG	6
11	3250-0295	SYRINGE GLASS TOP CLAMP	6
10	3250-0294	SYRINGE LUER EXTENSION	6
9	3250-0234	SYRINGE GLASS GASKET	6
8	3200-0317	SYRINGE BODY UPPER	1
7	3200-0316	SYRINGE BODY LOWER	1
6	3200-0208	3/8-16 LEAD SCREW, TEFLON COATED	2
5	3010-0021	SYRINGE PUMP GLASS	6
4	2800-0340	VERT. MOTOR/SENSOR ASS'Y	2
3	2700-0056	SYRINGE BACKLIGHT	1
2	2700-0007	PUMP POWER CABLE	1
1	2400-5187-TK	PUMP CONTROLLER PCB	1
ITEM	PART NO.	DESCRIPTION	QTY

CONFIDENTIAL INFORMATION
 THIS DOCUMENT CONTAINS PROPRIETARY INFORMATION
 AND SUCH INFORMATION IS NOT TO BE DISCLOSED TO
 OTHERS FOR ANY PURPOSE NOR USED FOR
 MANUFACTURING PURPOSES WITHOUT WRITTEN
 PERMISSION FROM DISTEK.

DISTEK
 121 NO. CENTER DR.
 NORTH BRUNSWICK, N.J. 08902

TITLE SYRINGE BODY ASSEMBLY ECLIPSE 5300	SCALE 1/3		
	SIZE B	SHEET OF 12	REV. C
	REVIEW ONLY		

A B C D E F G H J

1
2
3
4
5

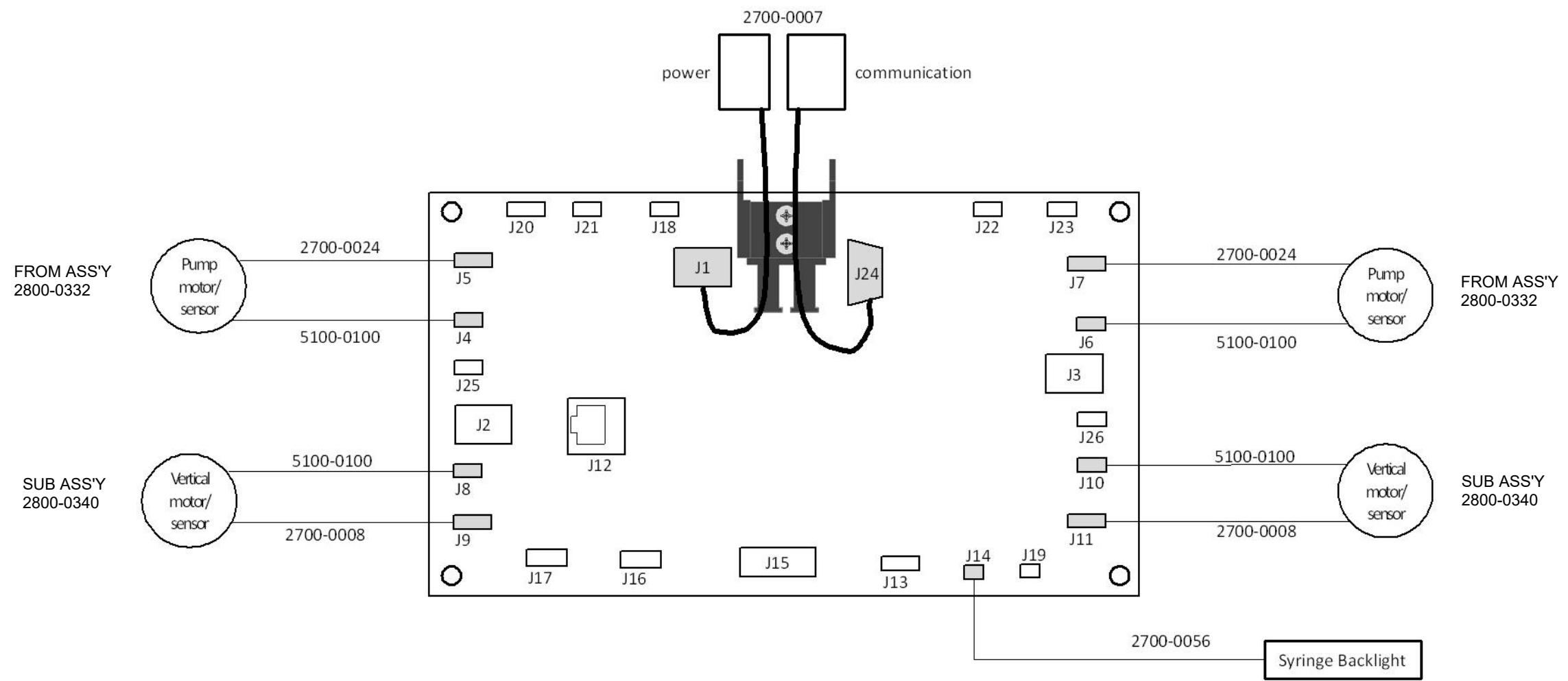

<p>CONFIDENTIAL INFORMATION THIS DOCUMENT CONTAINS PROPRIETARY INFORMATION AND SUCH INFORMATION IS NOT TO BE DISCLOSED TO OTHERS FOR ANY PURPOSE NOR USED FOR MANUFACTURING PURPOSES WITHOUT WRITTEN PERMISSION FROM DISTEK.</p>		<p>DISTEK 121 NO. CENTER DR. NORTH BRUNSWICK, N.J. 08902</p>	
TITLE		SCALE 1/3	
<p>SYRINGE BODY ASSEMBLY ECLIPSE 5300</p>		SIZE B	SHEET OF 22
		REV C	
REVIEW ONLY			